

SHIFTING TOOL

SBS & SBP SHIFTING TOOL

The Model “SB” Shifting Tool is a wireline operated tool used to open and close the circulating sleeve. The Model “SBS” Shifting Tool has selective keys, which require you to shear the pin in the shifting tool before releasing. After the tool is released, it will not engage any more sleeves.

The model “SBP” Shifting Tool has positive keys, which can be self-release from the sleeve after shifting. After the tool is released, they also can engage sleeve traveled in the hole.

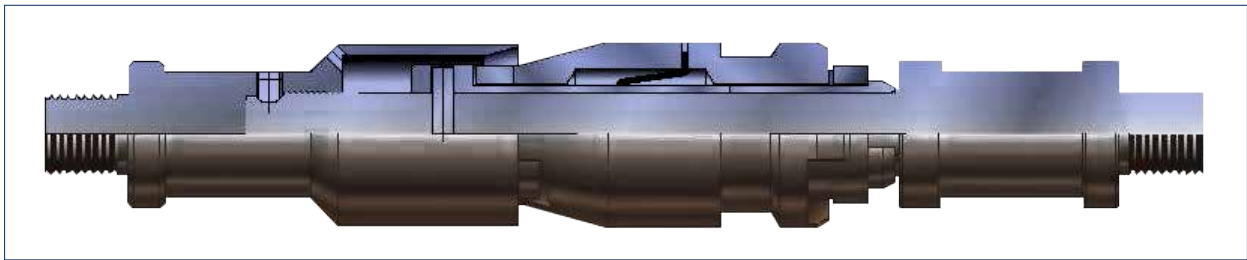

SPECIAL FEATURES

- The Automatic Locating Collet on the tool positively notifies the operator when the desired sleeve is reached. Running through two consecutive seal bores located two feet apart, indicates a sleeve
- Running through only one seal bore indicates a landing nipple
- Proof of Sleeve Shift. After completing a shift, an attempt to repeat the operation will give a surface indication that the shift was performed
- Safety Release. If the sleeve is opened in the presence of a differential pressure in favor of the annulus, the release mechanism is held inoperative by flow until the pressures equalize
- Emergency Release. The Shifting Tool has a shear pin release mechanism below the shifting Dogs for emergency release
- Deliberate Release. Even after the Shifting Tool is seated in a sleeve, it can be released without shifting the sleeve
- Open/Close Sequence. Upward jarring opens the sleeve. This allows the use of Hydraulic or Mechanical jars. Run in the inverted position, the tool will close the sleeve with downward jarring
- At least 6 feet, without restrictions, should be provided below the sleeve

TUBING SIZE		SIZE		PACKING SIZE	
in.	mm.	in.	mm.	in.	mm.
2 3/8	60.33	1.812	46.02	1.812	46.02
		1.875	47.63	1.875	47.63
2 7/8	73.03	2.313	58.75	2.250	57.15
				2.313	58.75
3 1/2	88.90	2.562	65.07	2.562	65.07
				2.750	69.85
				2.812	71.42