

## ST-2 ON-OFF TOOL

Model ST-2 On-Off Tool is a left-hand release, tubing disconnect device with an internal lock profile for securing flow control equipment. It is used in operations that require tubing disconnect and re-engagement without releasing the packer. The internal lock profile is used to retain flow control devices such as plugs, valves or chokes.

## SPECIAL FEATURES

- 1/4 turn Left-hand release, auto-on Optional right-hand release
- Bonded seals allow multiple disconnects
- Can be pinned in a shear-up or shear-down position
- Type SX internal lock profiles are standard

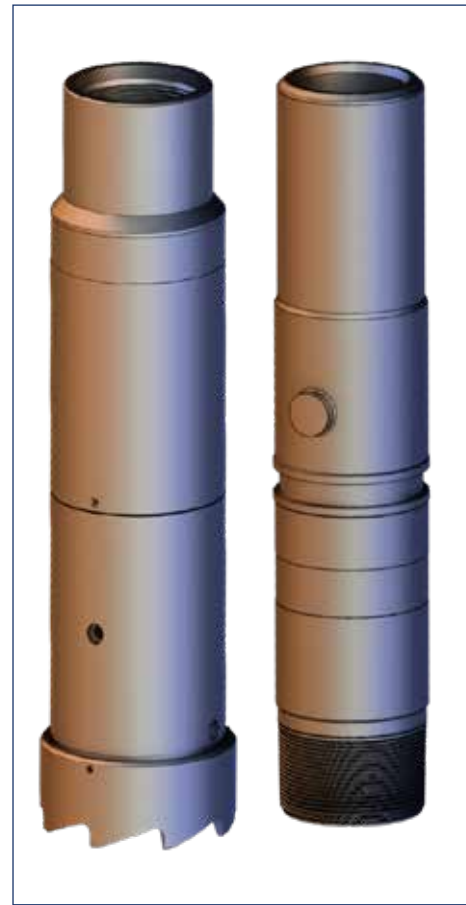

CASING SIZE		MAX OD		MIN ID		THREAD BOX X PIN IN.
in.	mm	in.	mm	in.	mm	
4 1/2	114.30	3.75	95.25	1.87	47.63	2 3/8 8RD EUE
5 1/2	139.70	4.50	114.30	2.31	58.75	2 7/8 8RD EUE
7	177.80	5.88	149.23	2.81	71.45	3 1/2 8RD EUE
7 5/8	193.68	6.25	158.75	2.31	58.75	2 7/8 8RD EUE
9 5/8	244.48	8.02	203.71	2.31	58.75	2 7/8 8RD EUE
				2.81	71.45	3 1/2 8RD EUE